

# PGM-FI Control System

## Troubleshooting Flowchart — Oxygen Sensor Heater

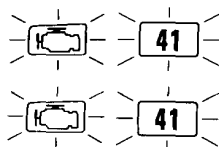

Self-diagnosis Check Engine light indicates code 41: A problem in the Oxygen (O<sub>2</sub>) Sensor Heater circuit.

- Engine is running.
- Check Engine light has been reported on, with service check connector jumped, CODE 41 is indicated.

Turn the ignition switch OFF.

Remove BACK UP fuse in the under-hood relay box for 10 seconds to reset ECU.

Start engine.

Is Check Engine light on and does it indicate CODE 41?

NO

YES

Stop engine.

Disconnect the 4P connector from the O<sub>2</sub> sensor.

Measure resistance between terminals A and B on the O<sub>2</sub> sensor.

Is there 10–40 Ω?

NO

Replace the O<sub>2</sub> sensor.

YES

Check for continuity to body ground on each terminal on the O<sub>2</sub> sensor.

Is there continuity?

YES

Replace the O<sub>2</sub> sensor.

NO

Check for continuity between terminal A and terminals C and D individually.

Is there continuity?

YES

Replace the O<sub>2</sub> sensor.

NO

(To page 6-11)

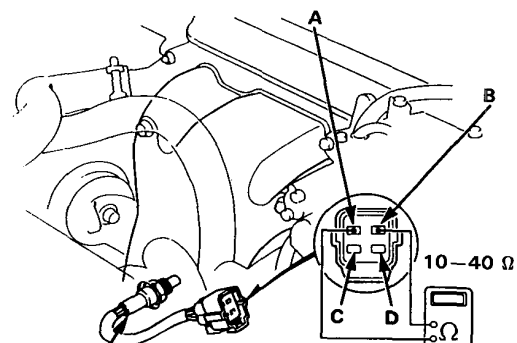

O<sub>2</sub> SENSOR  
45 N·m (45 kg-m, 33 lb-ft)

DIGITAL MULTIMETER  
07411-0020000

Intermittent failure, system is OK at this time (test driving may be necessary).  
Check for poor connections or loose wires at O<sub>2</sub> sensor and ECU.



(From page 6-10)

